

ASSEMBLY AND INSTALLATION



INSTRUCTION

Please read carefully and save this instruction, as you may need them at a later date.

CAUTION

Turn off the main power at the circuit breaker before installing the fixture, in order to prevent possible shock. If you are unfamiliar with proper electrical wiring connections, please consult of a qualified electrician before installing

Installing Step:

Remove the fixture and the mounting package from the box and make sure that no parts missing in the box.

1. Thread the Pipe (1) into Nipple (17). Attached the Diffuser (18), then thread the Pipe (2) into Pipe (1) with Hex Nut (20).
2. Attach the Arm (19), Arm (3), tube (4) and Cover (5), then screw with the Hex Nut (6) and Loop (7).
3. Thread the Nipple (9) into the Coupling with Hex Nut (8).

4. Install bulbs: (Bulbs not including in the package)

(Please don't exceed the maximum capacity that recommended on the Sockets)

5. Attached the Glass (10), Plastic washer (11), Metal Washer (12), then Screw with the Hex Nut (13).
6. Attach the Cover (14), then Screw with the Finial (16).

INSTALLATION IS NOW COMPLETED.

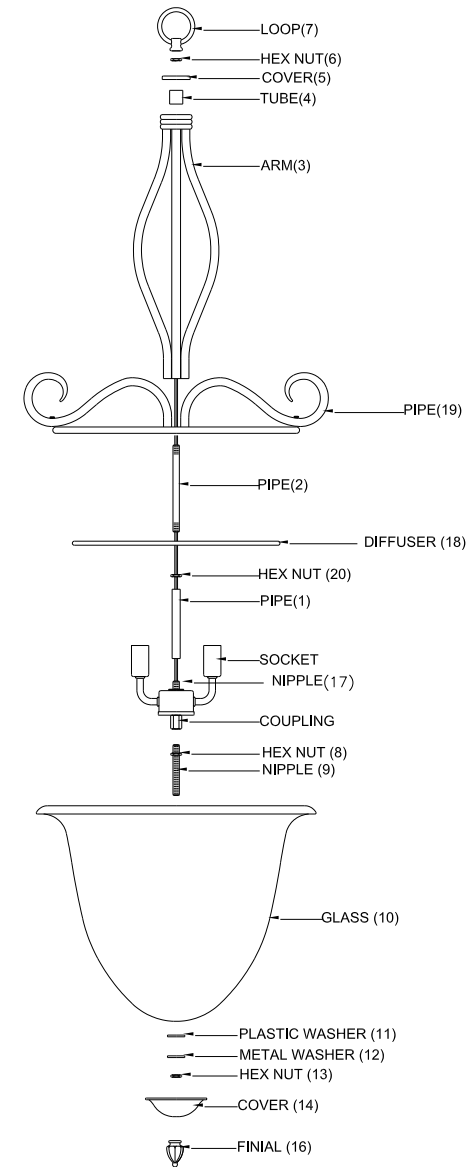

KP-SS-98-2-13