

NHIOICD-28 / NHIOICDCP-28

2" Iolite IC Air-Tight New Construction Housing

Source: 12W or 13W LED

800lm or 1000lm

Type

Project

Catalog No.

Notes

PRODUCT DESCRIPTION

New construction housing for use in insulated ceilings can be in direct contact with insulation. Air-tight construction provides energy savings by reducing the flow of air through the ceiling. Patented design allows for easy, tool-less removal of the driver.

SPECIFICATION

Housing: 0.040" Aluminum shallow housing can be installed in 1/2" ceiling thickness, an extension collar (NIO-2EXTC2) is available for ceiling thickness up to 2".

Patented Driver Assembly: Allows driver to slide out of housing without tools from the room side.

Air Flow Restriction: Meets requirements of Air-Tight (AT) <2CFM (cubic feet per minute) in accordance with ASTM-283 Air-Tight requirements.

Clearance: "IC" Insulated ceiling housings are direct contact rated. Not to be used in direct contact with spray foam insulation.

Bar Hangers: Two 13-3/4" to 24-1/2" adjustable bar hangers with captive nails are included on housing. Bar hangers are parallel to junction box, but can be repositioned 90° perpendicular to junction box if desired. "L"-shaped bar hanger foot to align to bottom of construction joist. A T-bar notch allows for easy installation in a suspended ceiling.

Junction Box: Pre-wired 25 cubic inch 0.064" thick galvanized steel, with seven 1/2" knockouts, four Romex® pryouts, and snap on covers. All leads are #18AWG wire, the ground wire is connected to the bottom, and quick connectors are supplied on all leads. Maximum of 8 no. 12 AWG through branch circuit conductors suitable for at least 90°C permitted in junction box. Junction box is accessible from the room side through housing opening.

ELECTRICAL	LE3	LE4	LUPEQ
Input Voltage	120V	120-277V	120/277V
Input Power	13W	12W	13W
Power Factor	≥0.90		
Dimming	Triac / ELV	Triac / ELV / 0-10V	Lutron EcoSystem
Operating Temp.	40°C max.		

COMPATIBLE TRIMS & MONOPOINTS

CATALOG NO.	DESCRIPTION
NIOB-2RC	2" Round Adjustable Cone Regress
NIOB-2SC	2" Square Adjustable Cone Regress
NIOB-2RG	2" Round Adjustable Surface Gimbal
NIOB-2SG	2" Square Adjustable Surface Gimbal
NIOB-2RNDCL	2" Round Deep Reflector
NIOB-2SNDCL	2" Square Deep Reflector
NIOB-2RPH	2" Round Pinhole
NIOB-2RPHA	2" Round Adjustable Pinhole
NIOB-2RSL	2" Round Adjustable Slot Aperture
NIOB-2RNB	2" Round Bullnose
NIOB-2SNB	2" Square Bullnose
NIOB-2SNDSQ	2" Square Reflector / Square Aperture
NIO-2RTLAL	2" Round Trimless Adjustable Reflector
NIO-2RTLNDCL	2" Round Trimless Reflector
NIOB-2RCY	2" iPOINT Cylinder
NIOB-2RTC	2" iPOINT Cone

Emergency: Housing can be specified with connections for emergency battery installation. Requires access above the ceiling. Must specify battery with remote test switch separately, [NEPK-07LEDUNV](#). *Note: Emergency is not compatible with Chicago plenum housings.*

LABELS AND LISTINGS

- cULus Listed for Damp Location (Wet Location when used with compatible trim)
- ENERGY STAR certified
- [5-Year Limited Warranty](#)
- RoHS Compliant
- FCC compliant
- Patent #D824567S
- Meets or exceeds ASTM-283 Air-tight requirements



PRODUCT IMAGES AND DIMENSIONS

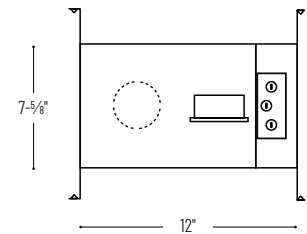
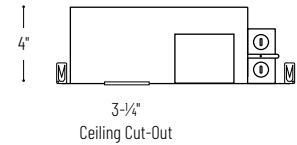

2" Iolite IC Air-Tight New Construction Housing - Compatible with NIOB-2, NIO-2 & NIOB-2

Housing Type	Driver / Dimming	Optional Emergency
NHIOICD-28 = IC Air-Tight	LE3 = 120V input; Triac / ELV dimming LE4 = 120-277V input; Triac / ELV / 0-10V dimming LUPEQ = 120/277V input; Lutron Hi-lume Premier 0.1% EcoSystem with Soft-On, Fade-to-Black (Consult factory)	/PEM = Pre-Wired for Remote Emergency
NHIOICDCP-28 = Chicago Plenum	LE3 = 120V input; Triac / ELV dimming LE4 = 120-277V input; Triac / ELV / 0-10V dimming LUPEQ = 120/277V input; Lutron Hi-lume Premier 0.1% EcoSystem with Soft-On, Fade-to-Black (Consult factory)	

Optional Accessories

Description
NEPK-07LEDUNV = Remote Emergency Battery w/Test Switch
NIO-2EXTC2 = Ceiling Extension Collar up to 2"

Example: **NHIOICD-28LE3** = 2" Iolite IC Air-Tight New Construction Housing, 120V input; Triac / ELV dimming