

ASSEMBLY INSTRUCTIONS

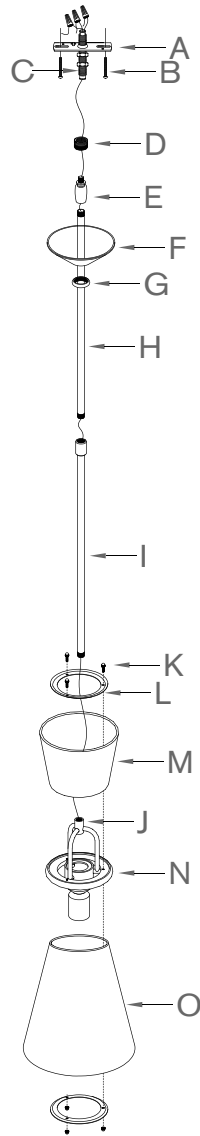

Clarkson Small Single Pendant

Item # ARN5033

WE RECOMMEND INSTALLATION OF THIS LIGHTING FIXTURE BE DONE BY A LICENSED ELECTRICIAN.

WARNING * SWITCH OFF THE MAIN ELECTRICAL SUPPLY FROM THE MAIN FUSE BOX/CIRCUIT BREAKER BEFORE INSTALLATION.**

INSPECT ITEM CAREFULLY BEFORE ATTEMPTING TO INSTALL. IF THERE IS ANY DAMAGE OR OBVIOUS DEFECT, DO NOT INSTALL.

ITEM MAY NOT BE RETURNED ONCE IT HAS BEEN INSTALLED.

1. Remove metal ring (L) from shade holder (N) by removing set screws (K), place shade (M) onto top of shade holder (N), place metal ring (L) onto the shade (M) and secure with set screws (K).
 2. Repeat the same procedure to install the shade (O).
 3. Screw the bottom nipple of pole (I) into top opening of connection rod (J) by turning in clockwise direction by hand until tight.
 4. Screw the bottom nipple of pole (H) into top opening of pole (I) by turning in clockwise direction by hand until tight.
 5. Screw connective rod (E) on top nipple of pole (H) by turning in clockwise direction by hand until tight.
 6. Screw mounting loop (D) onto top nipple of connective rod (E) by turning in clockwise direction by hand until tight.
 7. Unscrewing canopy ring (G), slide canopy ring (G) and canopy (F) on pole (H).
 8. Feed wire through poles (I) & (H), canopy (F), connective rod (E) and mounting loop (D).
 9. Attach mounting strap (A) to ceiling outlet box and secure with mounting screws (B).
 10. Insert top thread nipple (C) in mounting strap (A).
 11. Attach mounting loop (D) to thread nipple (C).
 12. Attach the bare copper ground wire from the fixture to the ground junction box wire (usually green or copper), fasten together with a plastic wire connector. Tightly wrap the wire connector with electrical tape. Be sure no wire strands are exposed.
- IT IS IMPERATIVE THAT THE OUTLET BOX IN YOUR HOME BE PROPERLY GROUNDED.

ASSEMBLY INSTRUCTIONS

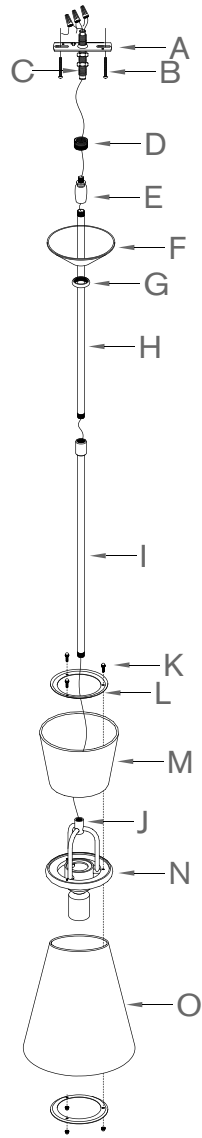

Clarkson Small Single Pendant

Item # ARN5033

WE RECOMMEND INSTALLATION OF THIS LIGHTING FIXTURE BE DONE BY A LICENSED ELECTRICIAN.

WARNING * SWITCH OFF THE MAIN ELECTRICAL SUPPLY FROM THE MAIN FUSE BOX/CIRCUIT BREAKER BEFORE INSTALLATION.**

INSPECT ITEM CAREFULLY BEFORE ATTEMPTING TO INSTALL. IF THERE IS ANY DAMAGE OR OBVIOUS DEFECT, DO NOT INSTALL.

ITEM MAY NOT BE RETURNED ONCE IT HAS BEEN INSTALLED.

13. Connect neutral wire from fixture (ridged molded wire) to the neutral wire from the junction box (usually white) . Fasten both wires together with a plastic wire connector and tightly wrap the wire connector with electrical tape. Be sure no wire strands are exposed.
14. Connect the hot wires from the fixture (smooth wire) to the hot wire (usually black) from the junction box. Fasten each together with a plastic wire connector and wrap the connection with electrical tape. DO NOT REVERSE THE HOT AND NEUTRAL CONNECTIONS OTHERWISE SAFETY WILL BE COMPROMISED.
15. Tuck the wire connections neatly into the ceiling outlet box.
16. Slip canopy (F) to ceiling and secure with canopy ring (G).
17. Insert light bulbs (not included) into sockets.

*** Clean with a dry, soft cloth only. Do not use harsh abrasives or chemical agents.

