

Project:

Ply LED Sconce Spec Sheet

SKU: 7230.72-WL Learn more at:
<https://sonnemanlight.com/ply-led-sconce>

Description: A solid aluminum shade drapes softly over an optical acrylic diffuser that directs LED illumination down and to the sides of these elegantly simple outdoor shapes.

Type #:

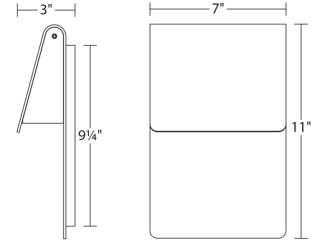

Dimensions

Height:	11"
Width:	7"
Extends:	3"
Minimum Extension:	3"
Maximum Extension:	3"
Canopy/Backplate/Base Depth:	6
Canopy/Backplate/Base Height:	9.25

Electrical Specs

Bulb(s) Included?:	Yes
Bulb 1 Type:	Integral LED
Input Voltage:	120VAC
Wattage:	16
Initial Lumens:	1260
Delivered Lumens:	281
Color Temperature:	3000K
CRI:	90
Power Supply Type:	Driver
Power Supply Quantity:	1
Power Supply Location:	Outlet Box
Dimming Type:	TRIAC/ELV
Bulb Max Wattage:	16

Installation

Installation:	Licensed electrician required
Installation Orientation:	Vertical

Shipping

Carton 1 L x W x H:	14" X 10" X 8"
Carton 1 Gross Weight:	4 LBS
Fixture Weight:	3

Shade

Shade 1 Material:	Aluminum w/Optical Acrylic
-------------------	----------------------------

Available Finishes

Available Finishes: Textured Bronze (.72), Textured Gray (.74), Textured White (.98)

General Listings

Features:	Wet Rated
Certification:	C-ETL-US
Color/Finish:	Textured Bronze (.72)
Dark Sky Friendly:	N