

Installation Instructions

IMPORTANT: READ PRIOR TO ATTEMPTING INSTALLATION

NUDTW-88 SERIES

LEDUR TW LED 120V TUNABLE WHITE EDGE-LIT UNDER CABINET

INSTALLATION SHOULD BE CARRIED OUT BY YOUR LOCAL ELECTRICIAN.

ALWAYS TURN OFF MAIN POWER BEFORE INSTALLATION

IMPORTANT:

- These products may represent a possible shock or fire hazard if improperly installed or attached in any way. Products should be installed in accordance with these instructions, current electrical codes and/or the current National Electric Code (NEC).
- Injury to persons and damage to the fixture and/or mounting surface may result if the fixture is pulled from the surface.
- To reduce the likelihood of such injury or damage, mount on a surface that is mechanically sound.
- Keep fixture away from curtains and other combustible materials.

INSTRUCTIONS:

MOUNTING THE FIXTURE

1. Remove captive mounting screw covers.
2. Place fixture in desired position and drive Mounting Screws Securely.
In some installations it may be desired to drill a pilot hole for the screws.
3. Replace the Captive Mounting Screw Cover.

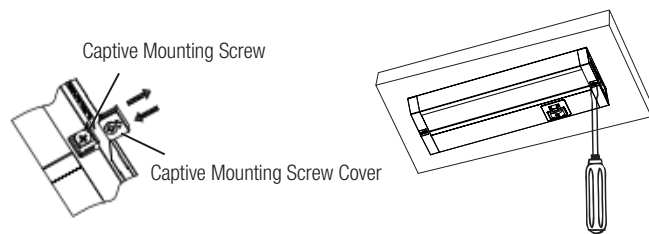

POWER CORD CONNECTION

Remove the Electrical Port Cover and insert the power cord into INPUT electrical port.

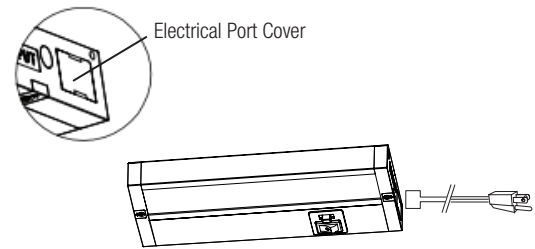

NOTE: Should captive mounting not line up with application, there are key-hole mounting holes under front cover.

NOTE: Port covers are labeled "INPUT" and "Output". Use "INPUT" for power and "OUTPUT" when linking to another NUDTW unit.

JOINING MULTIPLE FIXTURES:

USING JUMPER CORD:

1. Remove Electrical Port Covers.
2. Connect INPUT of Jumper cord to INPUT of electrical port.
3. Connect OUTPUT of Jumper cord to OUTPUT of electrical port.

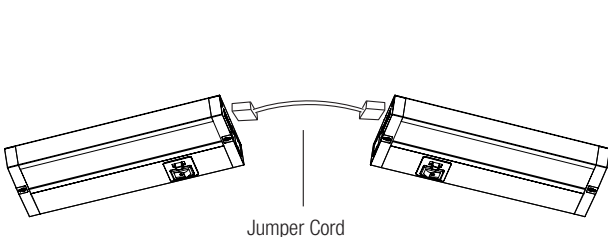

USING END-TO-END CONNECTOR

1. Remove Electrical Port Covers.
2. Connect INPUT of End-to-End connector to INPUT of electrical port.
3. Connect OUTPUT of End-to-End connector to OUTPUT of electrical port.

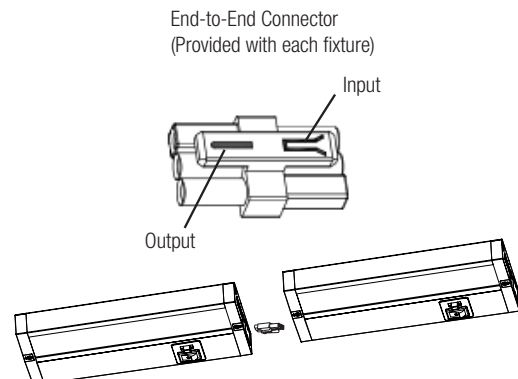

Installation Instructions

IMPORTANT: READ PRIOR TO ATTEMPTING INSTALLATION

NUDTW-88 SERIES

LEDUR TW LED 120V TUNABLE WHITE EDGE-LIT UNDER CABINET

INSTALLATION SHOULD BE CARRIED OUT BY YOUR LOCAL ELECTRICIAN.

ALWAYS TURN OFF MAIN POWER BEFORE INSTALLATION

WIRING CONNECTIONS THROUGH A REAR ACCESS DOOR

1. Loosen screw that secures the Side Access Door and remove the door from key hole by just sliding the door. (Fig. 1)
2. Assemble the 3/8" die-cast connector into Side Access Door (Fig. 2) and push the supply cable through the die-cast connector. (Fig. 3)
3. Inside fixture, are three wires with Push-in connectors. Carefully pull these out of the fixture. NOTE: Do not pull with excessive force.
4. Insert each of the three wires from the supply cable into each of the three Push-in connectors with respective color wires.
5. Neatly push wires and push-in connectors into opening in back of the fixture.
6. Close the Side Access Door and tighten screw.

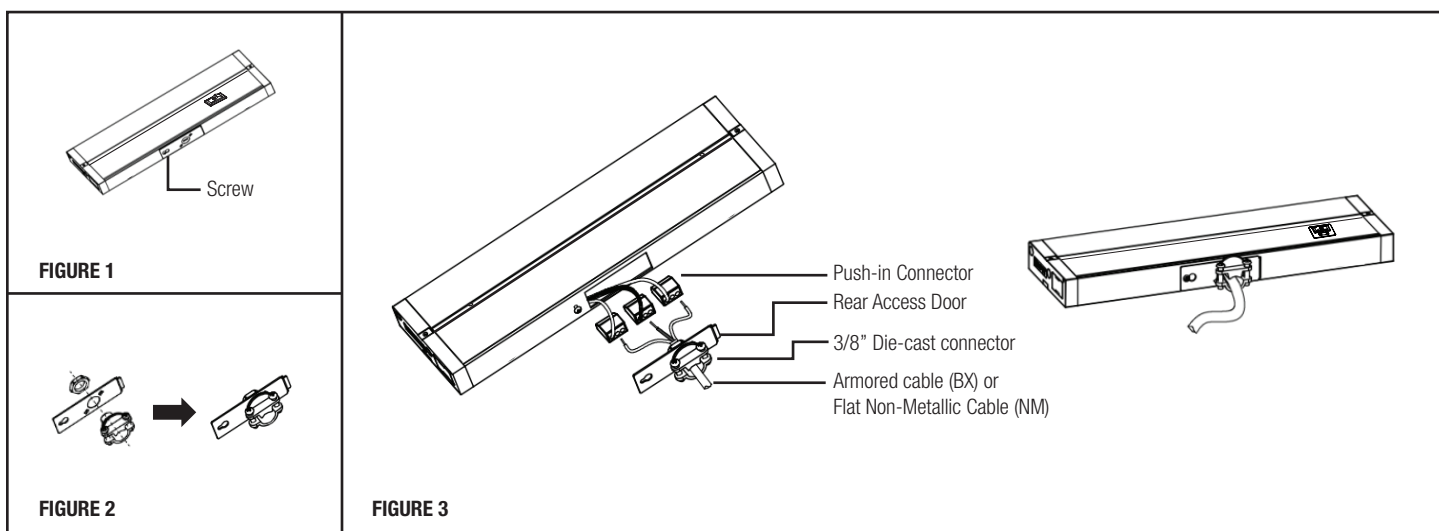

ALTERNATE POWER METHODS

There are KO's on the top and rear should the rear access not meet the requirements. If using these KO's it will require you to open hinged front cover to complete wiring. Gently pry open cover with tool provided or with a small regular screw driver. Make wiring connections. To close door, swing up next to unit and snap in place.

The NUDTW can also be powered using "Input" ports with a cord and plug or hard wire accessories purchased separately.

CCT SELECTION:

1. CCT selection can be achieved by changing the 3-positions sliding switch located right next to the on/off switch.

